

1. INSTRUCTION FOR NEW MACHINE

- 1) It takes about 100 operation hours to enhance its designed performance.
- 2) Operate according to the 3 steps below and avoid excessive operation for the initial 100 hours.

| Service meter | Load |
|-----------------|-----------|
| Until 10 hours | About 60% |
| Until 100 hours | About 80% |
| After 100 hours | 100% |

※ Excessive operation may deteriorate the performance of machine and shorten the life of the machine.

3) Be careful during the initial 100 hours operation

- (1) Check daily for the level and leakage of fluids.
- (2) Check greasing points on a regular basis and grease all points as needed. Refer to greasing chart located on the machine.
- (3) Check over all hose connections, bolts, nuts and screws, on a daily basis.
- (4) Warm up the machine fully before operating.
- (5) Check all gauges occasionally during the operation.
- (6) Check if the machine is operating normally during operation.

4) After the initial 250 hours of operation replace the following:

| Checking items | Hours |
|---------------------------|-------|
| Engine oil | 250 |
| Engine oil filter | |
| Fuel filter element | |
| Fuel prefilter element | |
| Swing reduction gear oil | |
| Travel reduction gear oil | |
| Pilot line filter element | |

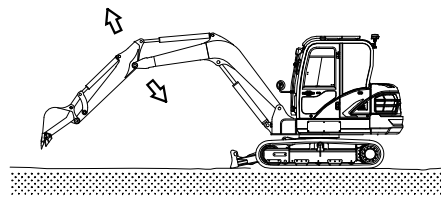

60A4OP01

2. CHECK BEFORE STARTING THE ENGINE

- 1) Look around and under the machine to check:
 - Check for loose nuts, bolts or wiring
 - Collection of dirt
 - Collection of dust at places which reach high temperature
 - Leakage of oil, fuel or coolant
 - Condition of the work equipment and hydraulic system.
- ※ **Refer to the daily check on the chapter 6, maintenance.**
- 2) Adjust seat to fit the contours of the operator's body for the pleasant operation.
- 3) Adjust the rear view mirror.

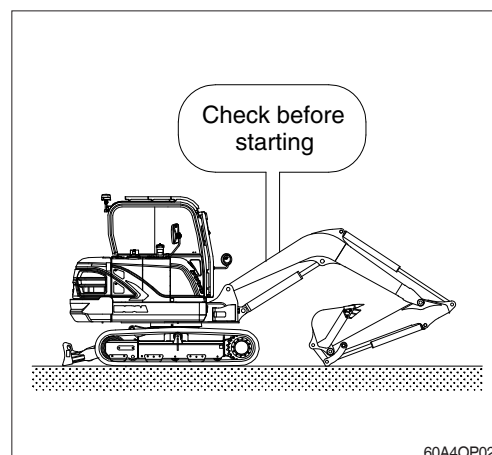

3. STARTING AND STOPPING THE ENGINE

1) CHECK INDICATOR LIGHTS

- (1) Confirm all operating levers are in the neutral position.
- (2) Turn the starting switch to the ON position.
Buzzer sounding for 4 seconds with HYUNDAI logo on cluster.
 - ※ If the ESL mode is set to the Enable (always) mode, enter the password to start engine.
 - ※ If the incorrect password is entered a total of 5 times, you must wait 30 minutes before trying again.
 - ※ Refer to page 3-21 for ESL mode.
- (3) After initialization of cluster, the operating screen is displayed on LCD (1).
Also, self-diagnostic function is carried out.

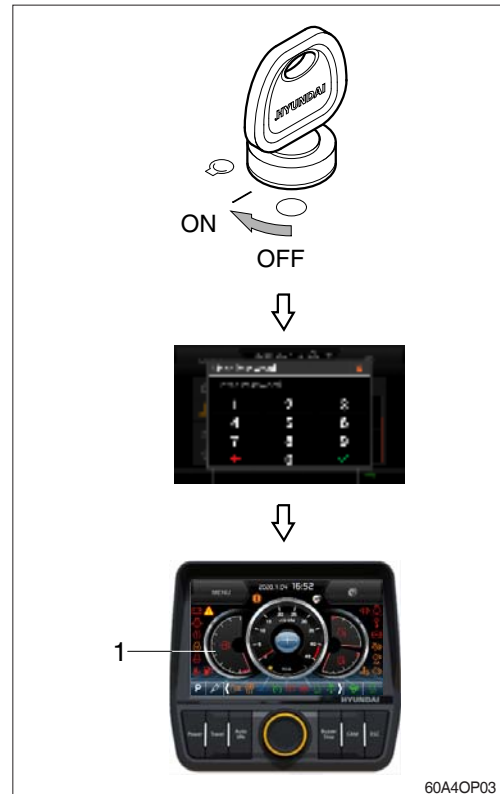

2) STARTING ENGINE IN NORMAL TEMPERATURE

- ※ Sound the horn to warn the surroundings after checking if personnel or obstacles are in the area.
- (1) Turn the accel dial to low idle position.
 - (2) Turn the starting switch to START position to start the engine.
 - ※ Do not hold the starting switch in the START position for longer than 20 seconds.
The start system may be seriously damaged.
 - ※ If the engine does not start, allow the stator to cool for about 2 minutes before re-attempting to start the engine again.
 - (3) Release the starting switch instantly after the engine starts to avoid possible damage to the starting motor.

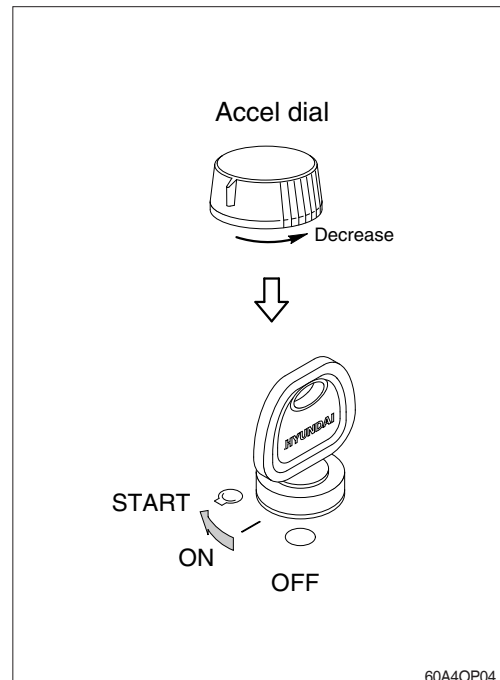

3) STARTING ENGINE IN COLD WEATHER

- ※ Sound horn to warn surroundings after checking if there are obstacles in the area.
- ※ Replace the engine oil and fuel referring to recommended oils at page 2-25.
- ※ Fill the anti-freeze solution to the coolant as required.
- ※ If you turn ON the starting switch, the fuel warmer is automatically operated to heat the fuel by sensing the coolant temperature.

- (1) Check if all the levers are in the neutral position.
- (2) Turn the accel dial switch to low idle position.
- (3) Turn the starting switch to the ON position, and wait the preheat pilot lamp turns off.
- (4) Turn starting switch to the START position to start the engine.
 - ※ If the engine does not start, allow the starter to cool for about 2 minutes before attempting to start the engine again.
- (5) Release the starting switch immediately after starting engine.
- (6) If the temperature of the coolant is lower than 30°C the warming up automatically starts.
 - ※ Do not operate the working devices, or convert the operation mode into other mode during the warming up.

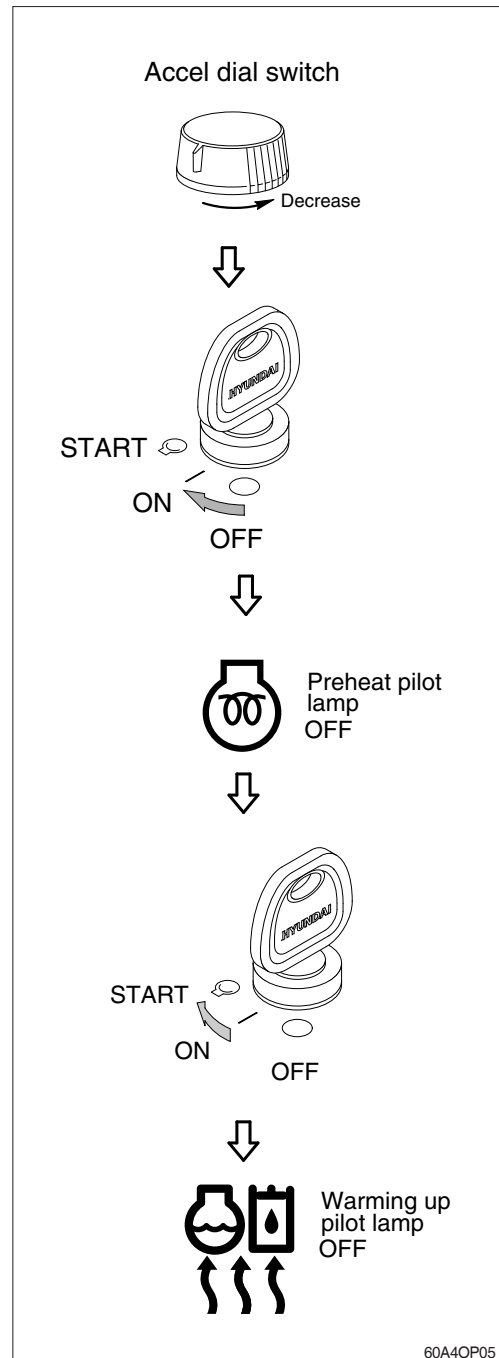

4) INSPECTION AFTER ENGINE START

Inspect and confirm the following after engine starts.

- (1) Is the oil level gauge of hydraulic tank in the normal operation range?
 - (2) Is there any leakage of oil or water?
 - (3) Are any warning lamps (3) ON?
The seat belt reminder warning lamp (4) pops up and the buzzer sounds until seat belt is fastened.
 - (4) Are indicators for coolant temperature gauge (1) and hydraulic temperature gauge (2) in the normal operating range?
 - (5) Are the engine sound and the color of exhaust gas normal?
 - (6) Are the sound and vibration normal?
- ※ **Do not increase engine speed quickly after starting, it can damage engine or turbocharger.**
 - ※ **If there are problems in the cluster, stop the engine immediately and correct problems as required.**



5) WARMING-UP OPERATION

- ※ **The most suitable temperature for the hydraulic oil is about 50°C(122°F).**
If the hydraulic oil temperature drops below 25°C(77°F), sudden operation can damage the hydraulic system. So temperature must be raised to at least 25°C(77°F) before starting work.
- (1) Run the engine at low idling for 5 minutes.
 - (2) Speed up the idling and run the engine at mid-range speed.
 - (3) Operate bucket lever for 5 minutes.
 - ※ **Do not operate anything except bucket lever.**
 - (4) Run the engine at the high speed and operate the bucket lever and arm lever for 5-10 minutes.
 - ※ **Operate only the bucket lever and arm lever.**
 - (5) Finally this warming-up process will be completed by operating all cylinders several times along with the operation of swing and traveling.
 - ※ **Increase the warming-up operation during winter.**

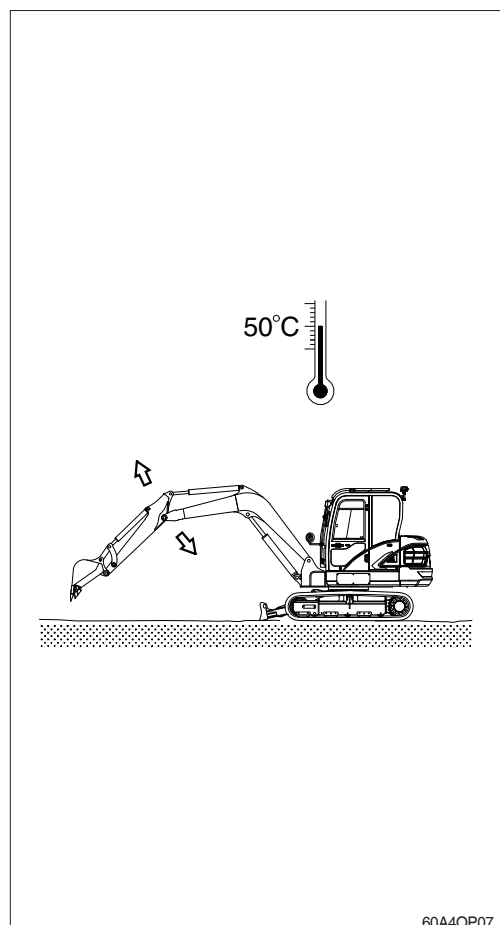

6) TO STOP THE ENGINE

- ※ If the engine is abruptly stopped before it has cooled down, engine life may be greatly shortened. Consequently, do not abruptly stop the engine apart from an emergency.
- ※ In particular if the engine has overheated, do not abruptly stop it but run it at low speed to allow it to cool gradually, then stop the engine.

- (1) Lower the bucket to the ground then put all the levers in the neutral position.
- (2) Run the engine at low idling speed for about 5 minutes.
- (3) Return the key of starting switch to the OFF position.
- (4) Remove the key to prevent other people using the machine and lock the safety knob.
- (5) Lock the cab door.

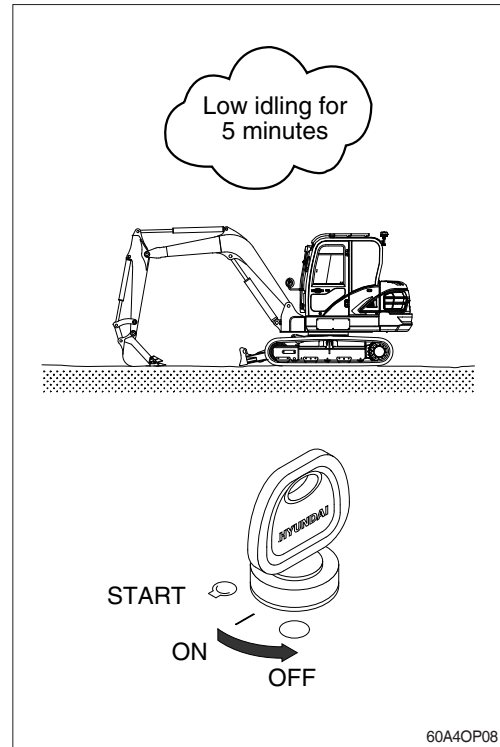

4. OPERATION OF WORKING DEVICE

※ **Confirm the operation of control lever and working device.**

- 1) Left control lever controls arm and swing.
- 2) Right control lever controls boom and bucket.
- 3) When you release the control lever, control lever returns to neutral position automatically.

※ **When operating swing, consider the swing distance by inertia.**

※ **Before starting the job or when travelling up or down a slope, position and keep the angle blade at neutral. (if equipped the angle blade)**

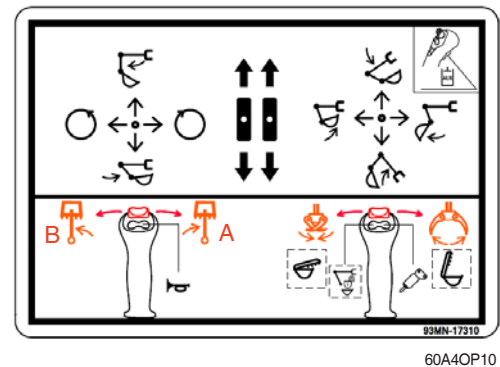
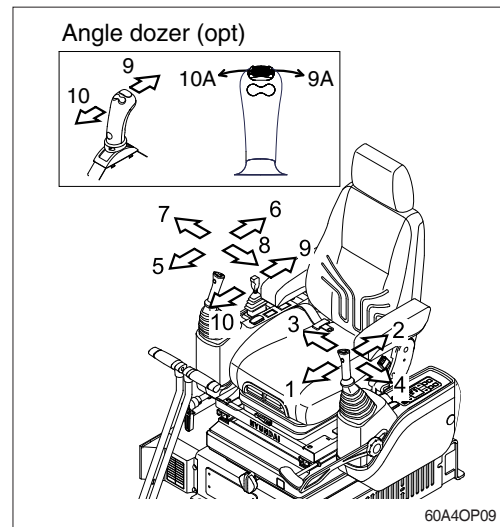

※ **Left control lever**

- 1 Arm roll-out
- 2 Arm roll-in
- 3 Swing right
- 4 Swing left
- A Boom swing right
- B Boom swing left

※ **Refer to page 3-42 for switch operation on LH RCV lever.**

※ **Right control lever**

- 5 Boom lower
- 6 Boom raise
- 7 Bucket roll-out
- 8 Bucket roll-in

※ **Dozer control lever**

- 9 Dozer blade up
- 10 Dozer blade down
- 9A Dozer blade tilting left
- 10A Dozer blade tilting right

※ **Refer to page 3-42 for switch operation on RH RCV lever.**

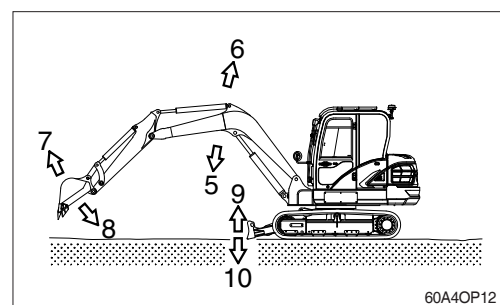
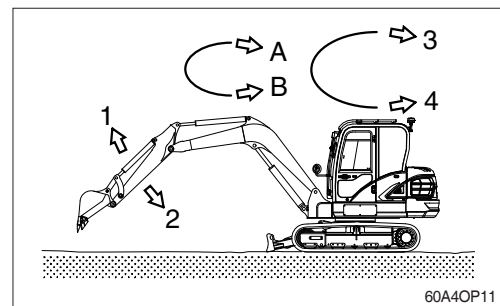

5. TRAVELING OF THE MACHINE

1) BASIC OPERATION

(1) Traveling position

The travel motor is in the rear and the working device is forward.

- ▲ **Be careful as the traveling direction will be the opposite when the machine is rotated 180°.**

(2) Traveling operation

It is possible to travel by either travel lever or pedal.

- ※ **Do not travel continuously for a long time.**
- ※ **Reduce the engine speed and travel at a low speed when traveling on uneven ground.**

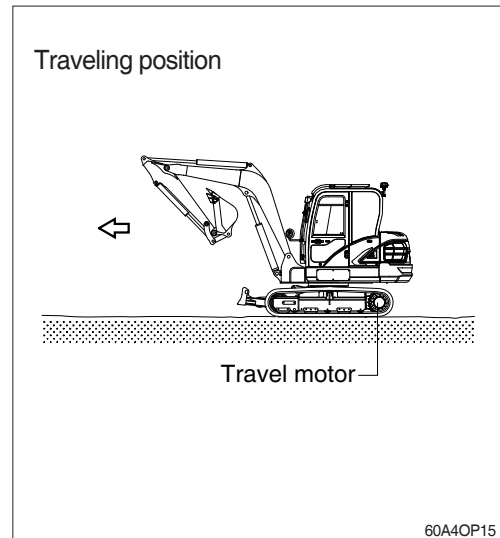

(3) Forward and backward traveling

When the left and right travel levers or pedals are pushed at the same time, the machine will travel forward or backward depending on your selection.

- ※ **The speed can be controlled by the operation stroke of lever or pedal and change of direction will be controlled by difference of the left and right stroke.**

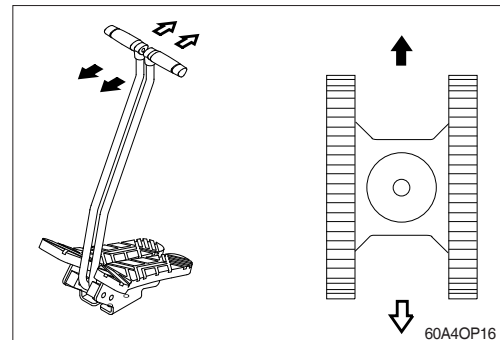

(4) Pivot turning

Operating only one side of lever or pedal makes the change of direction possible by moving only one track.

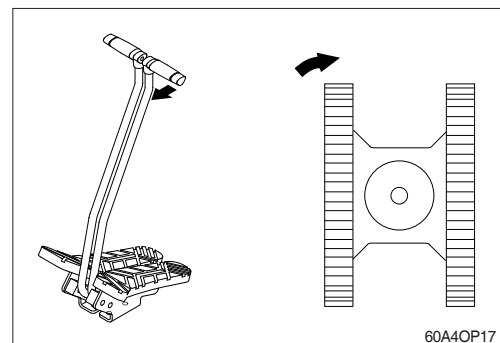

(5) Counter rotation

It is to rotate the undercarriage (only) while not advancing the machine forward or backward. This is accomplished by moving the travel levers and or pedals in the opposite direction of each other.

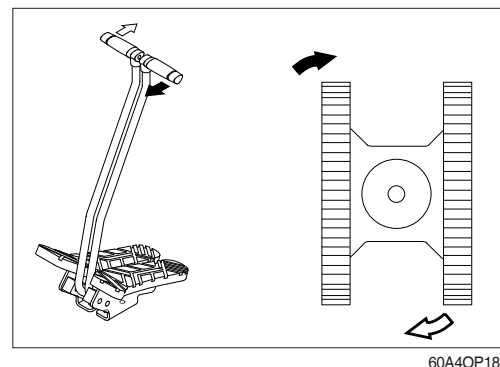

2) TRAVELING ON A SLOPE

- (1) Make sure that the travel lever is properly maneuvered by confirming the travel motor is in the right location.
 - (2) Maintain the bucket 20 to 30 cm (1 ft) from the ground so that it can be used as a brake in the event of an emergency.
 - (3) If the machine starts to slide or loses stability, lower the bucket immediately as it will help slow or stop the machine.
 - (4) When parking on a slope, use the bucket as a brake and place blocks behind the tracks to prevent sliding.
- ※ Machine cannot travel effectively on a slope when the oil temperature is low. Do the warming-up operation when it is going to travel on a slope.
- ▲ Be careful when working on slopes. It may cause the machine to lose its balance and turn over. Serious injury or death could occur.
- ▲ Be sure to keep the travel speed switch on the LOW (turtle mark) while traveling on a slope.

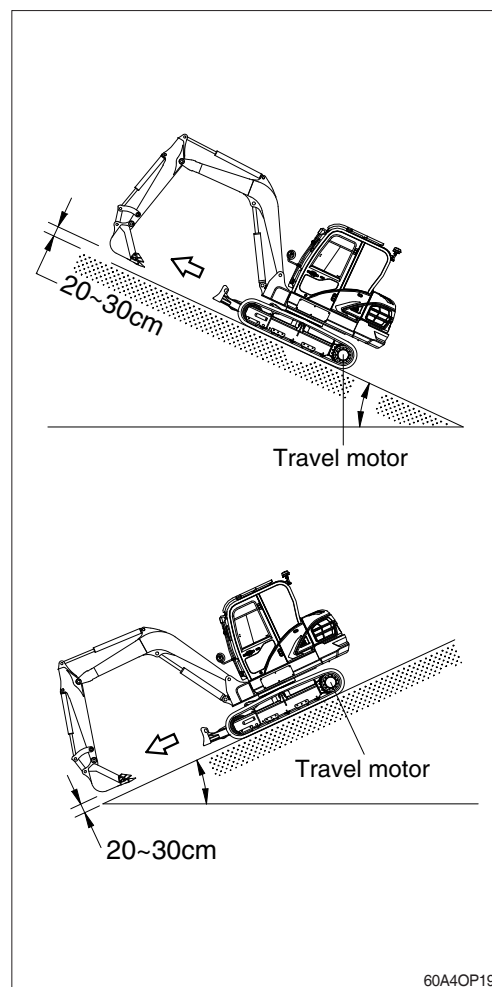

3) TRAVELING ON SOFT GROUND

- ※ If possible, avoid operating on soft ground.
- (1) Move forward as far as machine can move.
 - (2) Take care not to go beyond the depth where towing is impossible on soft ground.
 - (3) When driving becomes impossible, lower bucket and use boom and arm to pull the machine. Operate boom, arm, and travel lever at the same time to avoid the machine sinking.

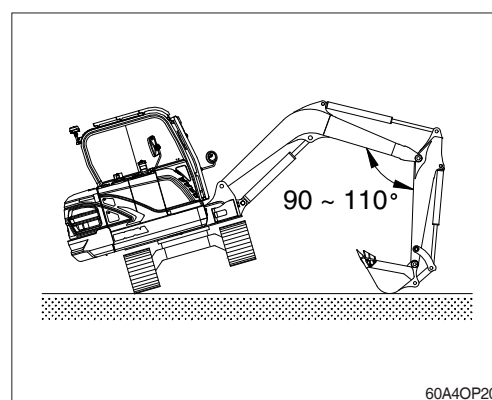

4) TOWING THE MACHINE

Tow the machine as follows when it can not move on its own.

- (1) Tow the machine after hooking the wire rope to the frame as shown in the upper right illustration.
- (2) Hook the wire rope to the frame and put a support under each part of wire rope to prevent damage.

※ **Never tow the machine using only the tie hole, because this may break.**

▲ **Make sure no personnel are standing close to the tow rope as serious injury or death could occur if it breaks.**

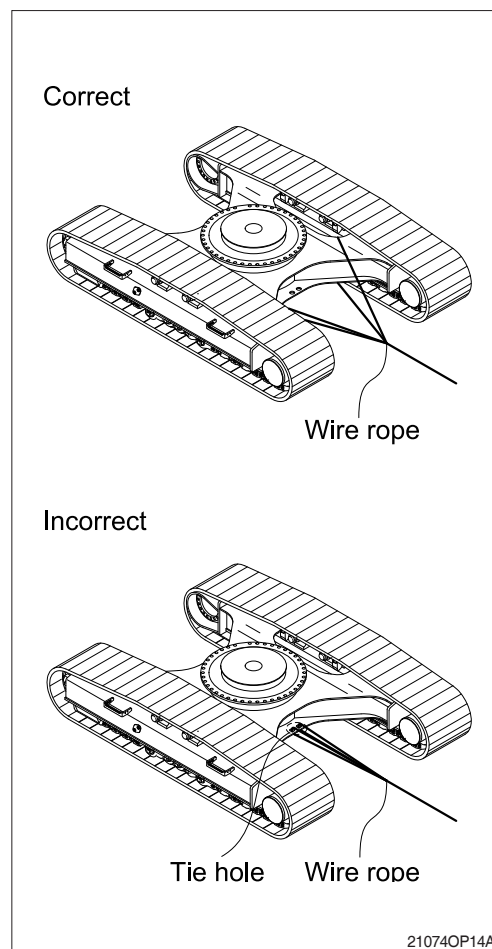

6. EFFICIENT WORKING METHOD

- 1) Do the digging work by arm.

Use the pulling force of arm for digging and use together with the digging force of the bucket if necessary.

- ※ **Consult the local regulations and instructions when using the dozer blade for additional machine stability. For the installation of a dozer cylinder safety valve, please contact your HD Hyundai Construction Equipment dealer.**

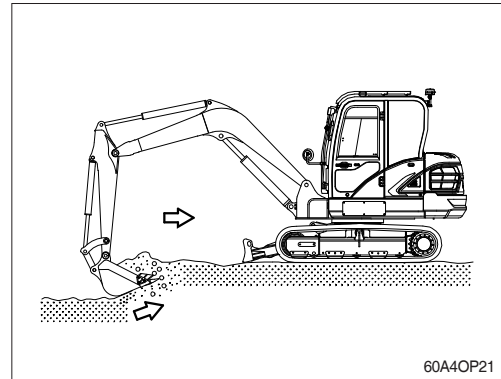

- 2) When lowering and raising the boom operate softly for the beginning and the end.

In particularly, sudden stops while lowering the boom may cause damage to the machine.

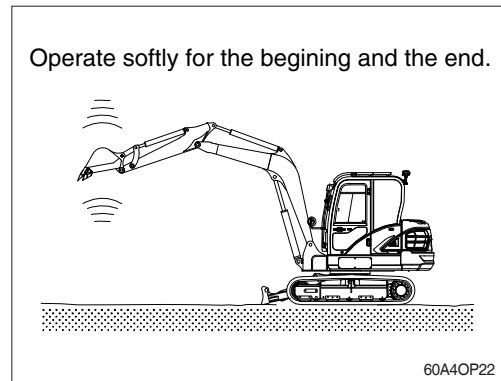

- 3) The digging resistance and wearing of tooth can be reduced by putting the end of bucket tooth to the digging direction.

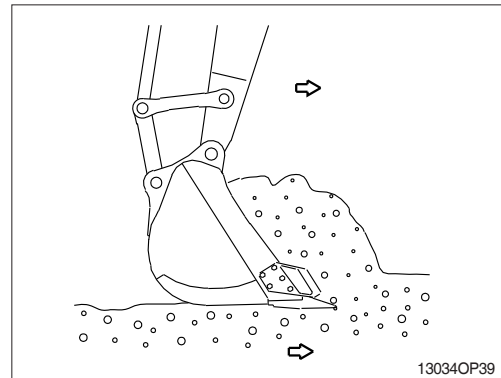

- 4) Set the tracks parallel to the line of the ditch to be excavated when digging ditch. Do not swing while digging.

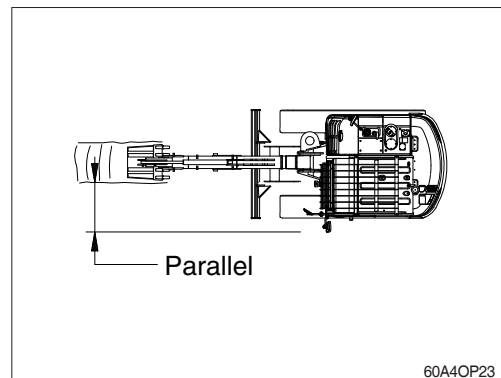

- 5) Dig slowly while keeping the angle of boom and arm at a 90-110° when maximum digging force is required.

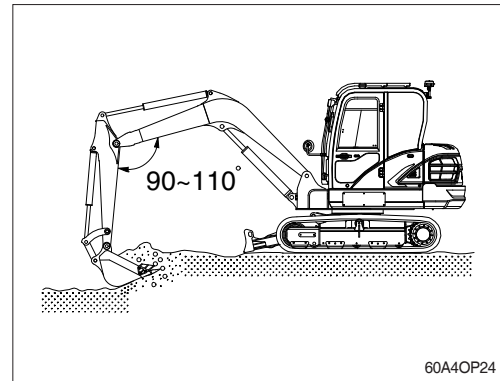

- 6) Leave a small margin of cylinder stroke to prevent damage of cylinder when working with the machine.

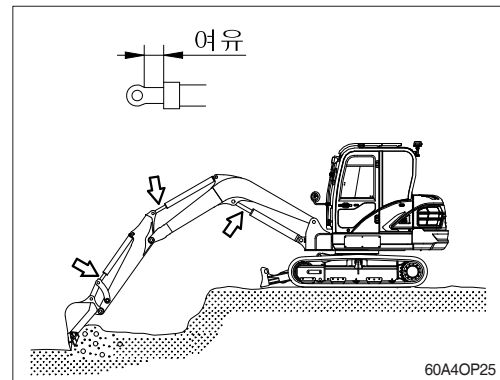

- 7) Keep the bucket to the dumping position and the arm horizontal when dumping the soil from the bucket.
Operate bucket lever 2 or 3 times when hard to dump.

※ Do not use the impact of bucket tooth when dumping.

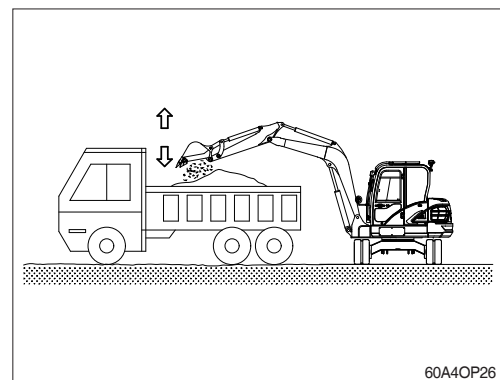

- 8) Operate stop of swing considering the swing slip distance is created by inertia after neutralizing the swing lever.

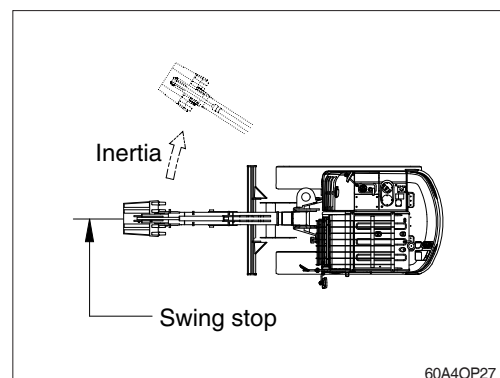

- 9) If the excavation is in an underground location or in a building, make sure that there is adequate overhead clearance and that there is adequate ventilation.

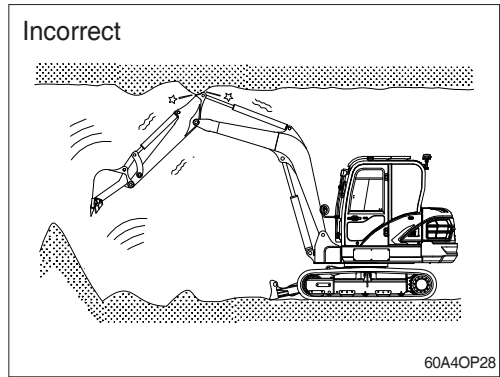

- 10) Do not use the dropping force of the work equipment for digging.
The machine can be damaged by the impact.

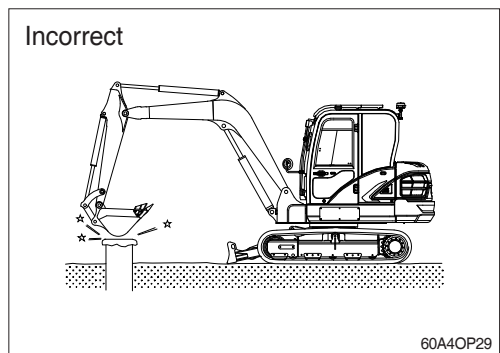

- 11) Do not use the bucket to crack hard objects like concrete or rocks.
This may break a tooth or pin, or bend boom.

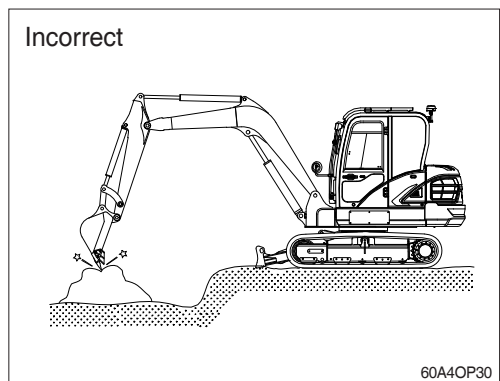

12) NEVER CARRY OUT EXCESSIVE OPERATIONS

Operation exceeding machine performance may result in accident or failure causing serious injury or death.

Never carry out operations which may damage the machine such as overload or over-impact-load.

Never travel while carrying a load.

※ Consult the local regulations and instructions for carrying out lifting operations. In accordance with EN 474-5 the machine must be equipped with following devices.

- a lifting device, f.e. lifting hook, lifting eye
- *an overload warning device (option)
- *safety valves on the arm and the boom cylinder (option)
- *a safety valve on the dozer cylinder (option)
if the dozer blade is used to increase the machine stability.

* : Please contact your HD Hyundai Construction Equipment dealer for installation.

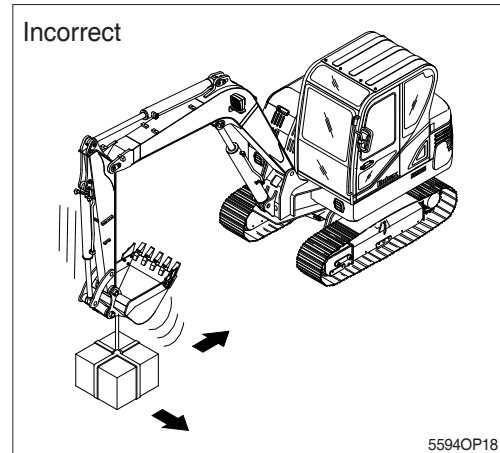

13) Prohibition to lift in case of exceeding performance

Lift exceeding machine capability causes machine malfunction and accident.

Perform lifting under the machine specifications.

※ Consult the local regulations and instructions for carrying out lifting operations. In accordance with EN 474-5 the machine must be equipped with following devices.

- a lifting device, f.e. lifting hook, lifting eye
- *an overload warning device (option)
- *safety valves on the arm and the boom cylinder (option)
- *a safety valve on the dozer cylinder (option)
if the dozer blade is used to increase the machine stability.

* : Please contact your HD Hyundai Construction Equipment dealer for installation.

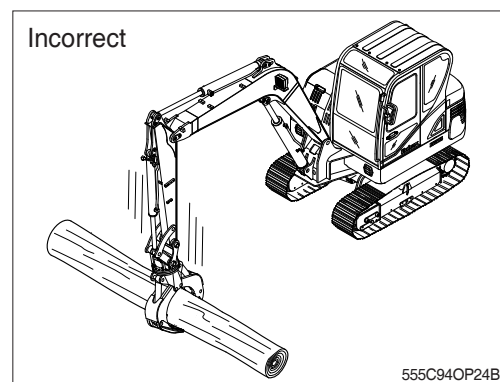

14) BUCKET WITH HOOK

When carrying out lifting work, the special lifting hook is necessary.

The following operations are prohibited.

- Lifting loads with a wire rope fitted around the bucket teeth.
- Lifting loads with the wire rope wrapped directly around the boom or arm.

When performing lifting operation, securely hook the wire rope onto the special lifting hook.

When performing lifting operation, never raise or lower a person.

Due to the possible danger of the load falling or of collision with the load, no persons shall be allowed in the working area.

Before performing lifting operation, designate an operation supervisor.

Always execute operation according to their instructions.

- Execute operating methods and procedures under their direction.
- Select a person responsible for signaling.
Operate only on signals given by such person.

Never leave the operator's seat while lifting a load.

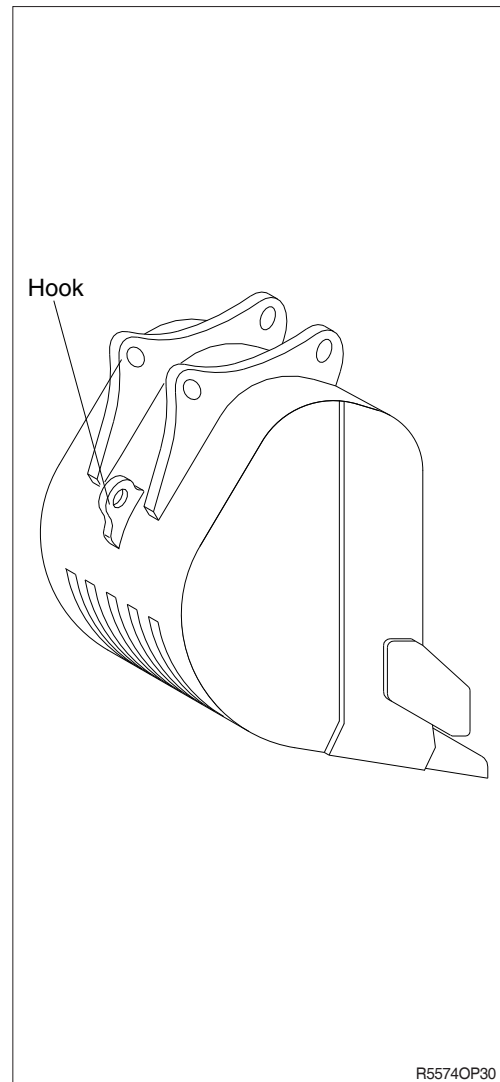

7. OPERATION IN THE SPECIAL WORK SITES

1) OPERATING THE MACHINE IN A COLD WEATHER

- (1) Use proper engine oil and fuel for the weather.
- (2) Fill the required amount of antifreeze in the coolant.
- (3) Refer to the starting engine in cold weather.
Start the engine and extend the warming up operation.
- (4) Be sure to open the heater cock when using the heater.
- (5) Always keep the battery completely charged.
※ **Discharged batteries will freeze more easily than fully charged.**
- (6) Clean the machine and park on the wood plates.

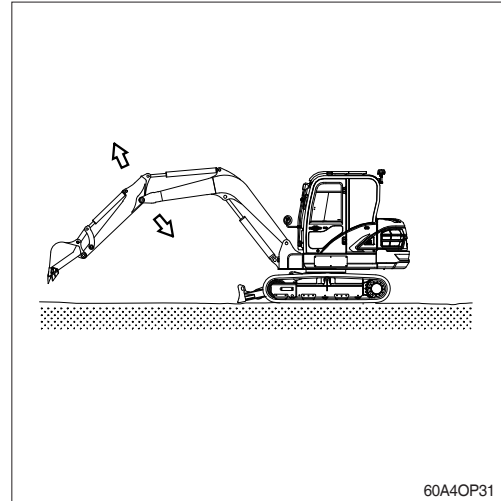

2) OPERATION IN SANDY OR DUSTY WORK SITES

- (1) Inspect air cleaner element frequently. Clean or replace element more frequently, if warning lamp lights up and buzzer sounds simultaneously, regardless of inspection period.
※ **Replace the inner and outer element after 6 times of cleaning.**
- (2) Inspect radiator frequently, and keep cooling fins clean.
- (3) Prevent sand or dust from getting into fuel tank and hydraulic tank during refilling.
- (4) Prevent sand or dust from penetrating into hydraulic circuit by tightly closing breather cap of hydraulic oil tank. Replace hydraulic oil filter frequently.
- (5) Keep all lubricated parts, such as pins and bushings, clean at all times.
- (6) If the air conditioner and heater filters clog, the heating or cooling capacity will drop. Clean or replace the filter element more frequently.
- (7) Clean electrical components, especially the starting motor and alternator, to avoid accumulation of dust.

3) SEA SHORE OPERATION

- (1) Prevent ingress of salt by securely tightening plugs, cocks and bolts of each part.
- (2) Wash machine after operation to remove salt residue.
Pay special attention to electrical parts hydraulic cylinders to prevent corrosion.
- (3) Inspection and lubrication must be carried out more frequently.
Supply sufficient grease to replace all old grease in bearings which have been submerged in water for a long time.

4) OPERATION IN MUD, WATER OR RAIN WORK SITES

- (1) Perform a walk around inspection to check for any loose fittings, obvious damage to the machine or any fluid leakage.
- (2) After completing operations, clean mud, rocks or debris from the machine. Inspect for damage, cracked welds or loosened parts.
- (3) Perform all daily lubrication and service.
- (4) If the operations were in salt water or other corrosive materials, make sure to flush the affected equipment with fresh water.

5) OPERATION IN ROCKY WORK SITES

- (1) Check for damage to the undercarriage and for looseness, flaws, wear and damage in bolts and nuts.
- (2) Loosen the track tension slightly when working in such areas.
- (3) Do not turn the undercarriage directly over the sharp edge rock.

8. NORMAL OPERATION OF EXCAVATOR

The following may occur during operation due to the nature of a hydraulic excavator.

- 1) When rolling in the arm, the roll-in movement stops momentarily at point X in the picture shown, then recovers speed again after passing point X. This is because movement by the arm weight is faster than the speed of oil flow into the cylinder.
- 2) When lowering the boom, you may hear continuous sound. This is caused by oil flow in the valve.
- 3) Overloaded movement will produce sound caused by the relief valves, which are for the protection of the hydraulic systems.
- 4) When the machine is swinging or stopped, a noise near the swing motor may be heard. The noise is generated when the brake valve relieves.

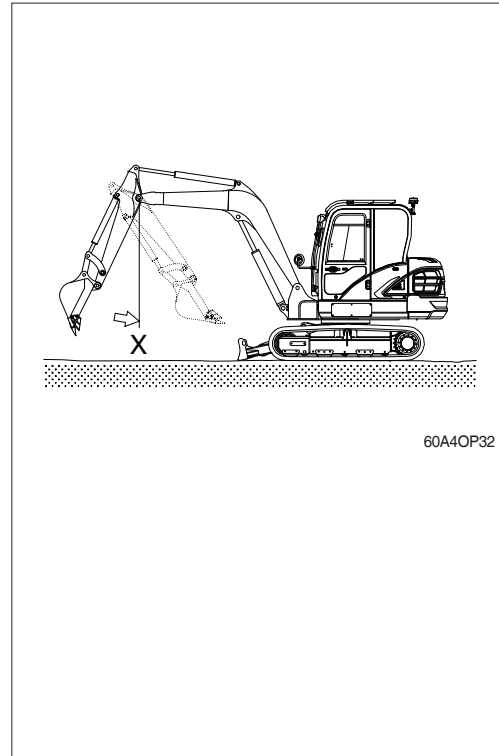

9. ATTACHMENT LOWERING (when engine is stopped)

- 1) On machines equipped with an accumulator, for a short time (within 2 minutes) after the engine is stopped, the attachment will lower under its own weight when the attachment control lever is shifted to LOWER. This happens only when the starting switch is ON and the safety knob is in the UNLOCK position. After the engine is stopped, set the safety knob to the LOCK position.

⚠ Be sure no one is under or near the attachment before lowering the boom. Failure to comply could result in serious injury or death.

- 2) The accumulator is filled with high-pressure nitrogen gas, and it is extremely dangerous if it is handled in the wrong way. Always observe the following precautions.

⚠ Never make any hole in the accumulator, expose it to flames or fire.

⚠ Do not weld anything to the accumulator.

※ When carrying out disassembly or maintenance of the accumulator, or when disposing of the accumulator, it is necessary to release the gas from the accumulator. A special air bleed valve is necessary for this operation, so please contact your HD Hyundai Construction Equipment distributor.

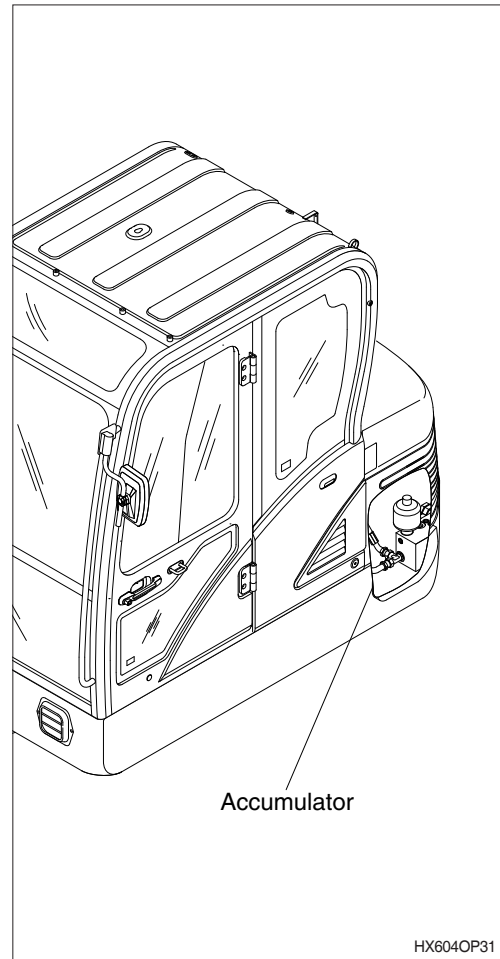

HX604OP31

10. STORAGE

When storing the machine for longer than 1 month, follow these procedures:

1) CLEANING THE MACHINE

Clean the machine. Check and adjust tracks.
Grease each lubrication part.

2) LUBRICATION POSITION OF EACH PART

Change all oil.

- ※ **Be particularly careful when you reuse the machine. As oil can be diluted during storage. Apply an anticorrosive lubricant on the exposed part of piston rod of cylinder and in places where the machine rusts easily.**

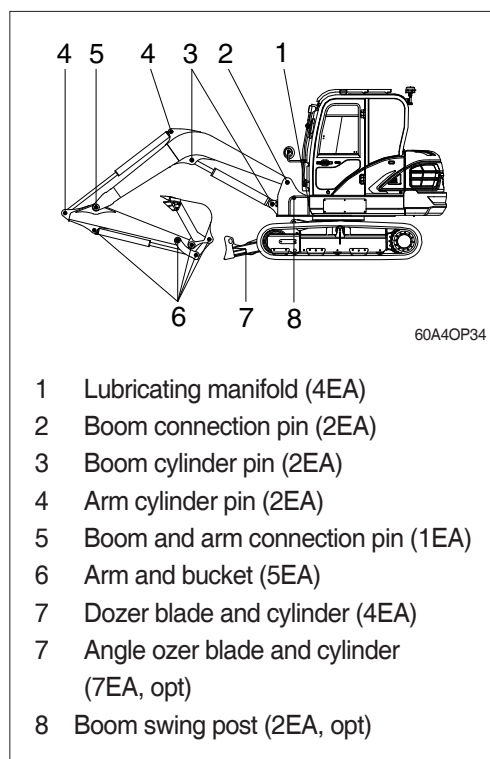

3) MASTER SWITCH

Turn OFF the master switch mounted in the rear cover of the cab.

- 4) Be sure to mix anticorrosive antifreezing solution in the radiator.

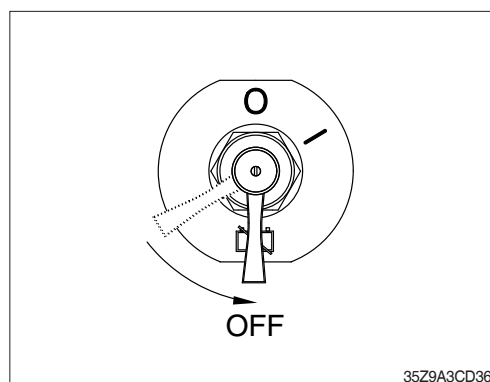

5) PREVENTION OF DUST AND MOISTURE

Keep machine dry. Store the machine setting wood on the ground.

- ※ **Cover exposed part of piston rod on cylinder.**
- ※ **Lower the bucket to the ground and set a support under track.**

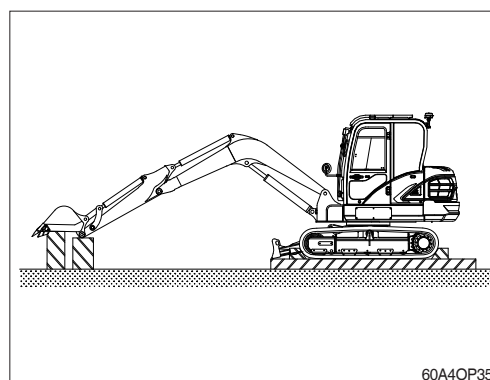

6) DURING STORAGE

Start engine and move the machine and work equipment once a month and apply lubrication to each part.

- ※ Check the level of engine oil and coolant and fill if required when starting engine.
- ※ Clean the anticorrosive on the piston rod of cylinder.
- ※ Operate the machine such as traveling, swing and work equipment operation to make sure enough lubrication of all functional components.

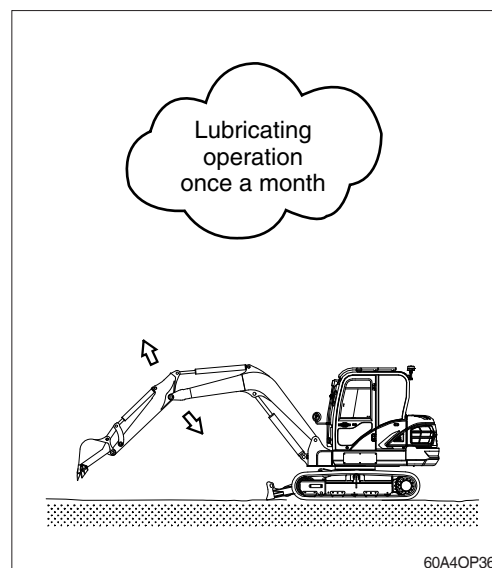

※ BATTERY

- ① Once a month, start the engine for 15 minutes (or use a charger) to charge the battery.
- ② Every 2 months, check the battery voltage and keep battery voltage over 12.54V.
- ③ If the machine stock period is over 6 months, disconnect the battery negative (-) terminal.

7) AFTER STORAGE

Carry out the following procedure when taking out of a long time storage.

- (1) Wipe off the anticorrosive lubricant on the hydraulic piston rod.
- (2) Completely fill fuel tank, lubricate and add oil.

(3) When storage period is over 6 months.

If the machine stock period is over 6 months, carry out the following procedure.

This procedure is to drain condensation water for the **swing reduction gear** durability.

- ※ Remove the drain port plug and drain the water until the gear oil comes out and then tighten the drain plug.
- ※ Refer to the service instruction, section 6 for the drain plug location.
- ※ If the machine is stored without carrying out the monthly lubricating operation, consult your HD Hyundai Construction Equipment dealer for service.

11. HANDLING THE RUBBER TRACKS

1) USING THE RUBBER TRACKS PROPERLY

Rubber tracks have some advantages over steel tracks.

However, you cannot take full advantage of them if you use them in the same manner as steel ones. Use care in operating with rubber tracks in accord with the conditions of the work site and the type of work.

Comparison table of rubber and steel tracks

| | Rubber | Steel |
|-------------------------------------|-----------|-----------|
| Low vibration | Excellent | Ordinary |
| Smooth travel | Excellent | Good |
| Silent travel | Excellent | Ordinary |
| Less damage to paved roads | Excellent | Ordinary |
| Simple handling | Excellent | Ordinary |
| Susceptibility to damage (strength) | Ordinary | Excellent |
| Drawbar full | Excellent | Excellent |

Rubber tracks have many advantages inherent in the unique properties of the material. On the other hand, however, they are low in strength. It is essential that you fully understand the properties of rubber tracks, and observe the precautions for operating and handling them to prolong their life and get the most out of them. Be sure to read this section for using the rubber tracks before using them.

2) WARRANTY FOR RUBBER TRACKS

The rubber tracks are not warranted for free repair or replacement if they are damaged because of misuse by the customer, including the failure to comply with the prohibitions and the instructions for safe operation; (for example, the failure to check the tension of the rubber tracks or service the rubber tracks properly, or "using the rubber tracks on surfaces and terrains which could physically damage them".)

3) PROHIBITIONS FOR USING THE RUBBER TRACKS

- (1) Do not operate or turn on surfaces of terrains that have sharp stones, a hard, uneven rock base, or that expose the tracks to steel rods, scrap iron, or edges of iron plates. Failure to observe these prohibitions may damage the rubber tracks.
- (2) Do not operate the machine on a stony surface like a riverbed. Doing this may damage the rubber tracks by catching gravel in the tracks or may cause the tracks to come off. Forcibly pushing obstacles will also shorten the life of the rubber tracks.
- (3) Prevent the rubber tracks from getting exposed to oil, fuel or chemical solvents. If they are exposed, immediately wipe them. Also, do not travel on roads which have oily surfaces.
- (4) When storing the rubber tracks for a long time period (more than three months), avoid placing them in a place subject to direct exposure to sunlight or rain.

- (5) Do not operate the machine when the tracks will be exposed to heat, (i.e., near an open-air fire, on a steel plate that has been exposed to the blazing sun, or on a hot asphalt road.)
- (6) Never run on one rubber track while the other is held above the ground with the implement. Doing this may damage the rubber track or cause it to come off.

4) PRECAUTIONS FOR USING THE RUBBER TRACKS

Observe the following precautions when operating the machine :

- (1) Never spin-turn on concrete or asphalt roads.
- (2) Do not change course suddenly. Doing this will cause the rubber track to wear early or be damaged.
- (3) Do not turn the machine across a large level gap while traveling . Remember that running over a level gap at a right angle will prevent the track from coming off.
- (4) Slowly lower the machine after it has been lifted above the ground with the implement.
- (5) It is not recommended that the machine be used to handle any materials that become oily after being crushed (e.g., soybeans, corn, rapeseed oil seeds, etc.). After unavoidably using the machine to handle such materials, clean the tracks with water.
- (6) It is not recommended that the machine be used to handle materials such as salt, ammonium sulfate, potassium chloride, potassium sulfate, or superphosphate of lime. Handling these materials may affect the core metal adversely. After using the machine to handle such materials, clean the tracks with water.
- (7) Do not operate the machine at the seashore. Doing this may affect the core metal adversely due to the salt content.
- (8) If a rubber track is cracked, it could be easily damaged when exposed to salt, sugar, wheat, or soybeans. Be sure to repair any cracks in the rubber track to prevent rubber chips from getting into the materials being handled.
- (9) Do not allow the rubber track to rub against a concrete wall.
- (10) The rubber tracks are prone to slip on snow or on a frozen road. Be careful of skidding when traveling or operating on a slope in cold weather.
- (11) Operating the machine in extremely cold weather will deteriorate the rubber tracks, shortening their life.
- (12) Use the rubber tracks between -25°C to +55°C (-13°F to +131°F) because of the physical characteristics of rubber.
- (13) Be careful not to damage the rubber tracks with the bucket while operating the machine.

5) BE CAREFUL NOT TO COME OFF THE RUBBER TRACKS

Keep the tracks in appropriate tension to prevent them from coming off.

If the tension is too low, the rubber tracks may come off under the following conditions.

Even if the tension is adequate, take care when operating the tracks under these conditions.

Some illustrations in this section can be different from your machine.

- (1) Do not steer the machine at an angle other than 90 degrees across a large level gap created by a curbstone or a rock [approximately more than 20 cm (8")]. Run over a level gap at a right angle only to prevent the tracks from coming off.

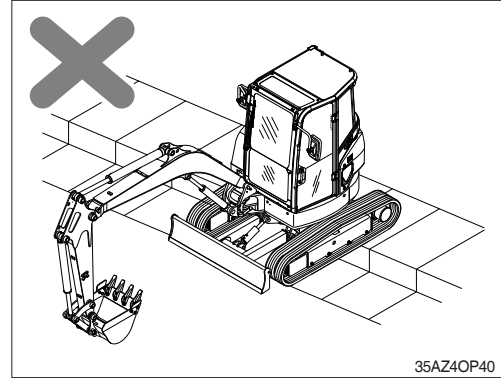

- (2) Do not steer the machine across a boundary between the flat ground and a slope, while moving backwards. If such travel is not avoidable, slow down the speed.

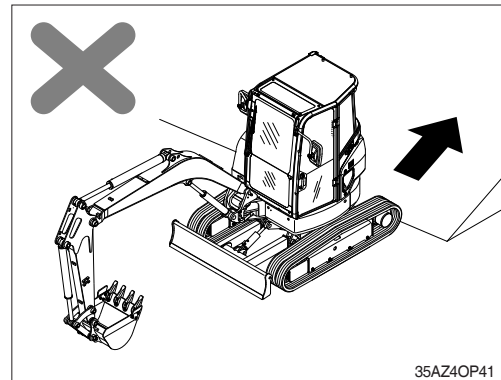

- (3) Do not travel with the track on one side on a slope or on convex ground (causing a machine angle of more than 10 degrees), and with the track on the other side on flat ground, to prevent the rubber track from being damaged. Be sure to travel with the tracks on both sides on the same level surface.

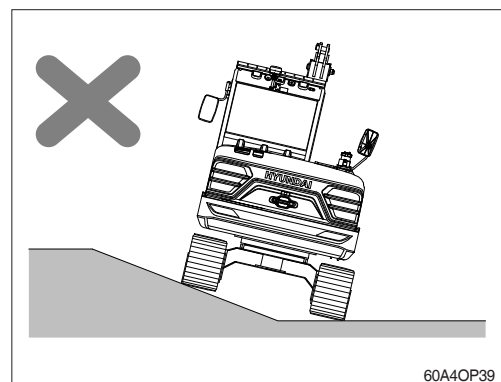

- (4) The three cases illustrated above are those which could cause the rubber tracks to loosen. In addition, do not subject machine to such ground conditions as are illustrated in the figure at the right.

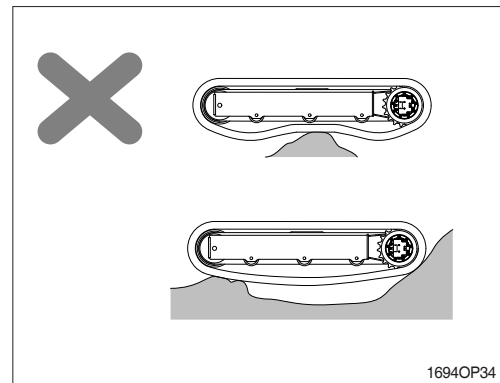

(5) HOW THE RUBBER TRACKS COME OFF

When running over a level gap, a clearance is created between the tracks and the track rollers. At this point, the tracks tend to come off.

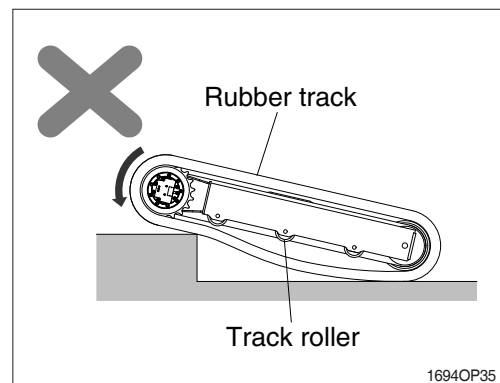

- (6) If the machine is traveling in reverse, clearance may also be created between the track rollers and the rubber tracks, and between the idlers and the rubber tracks, causing the rubber tracks to come off.

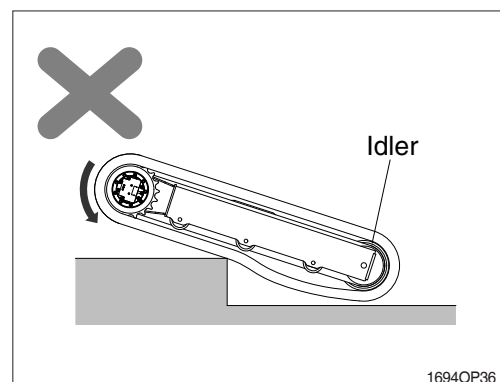

(7) Other situations to be avoided.

- ① When the machine changes the travel direction while the rubber tracks are blocked sideways by an obstacle or the like.
- ② When the idler and the track rollers are misaligned from the core metal, due to rubber track misalignment.

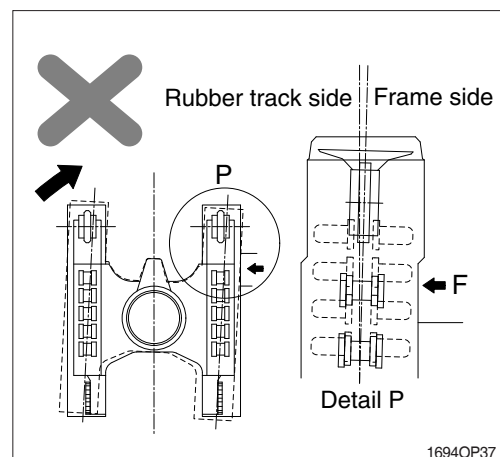

- ③ Traveling in reverse under the condition illustrated will cause the rubber tracks to come off.

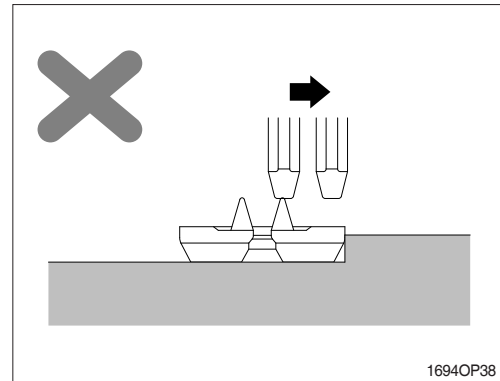

- ④ Changing the travel direction of the machine under the condition illustrated will cause the rubber tracks to come off.

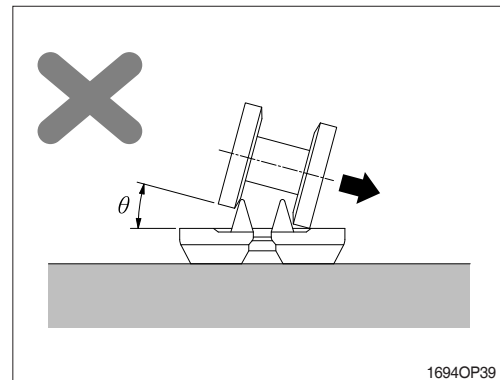

12. RCV LEVER OPERATING PATTERN

1) PATTERN CHANGE VALVE NOT INSTALLED (standard)

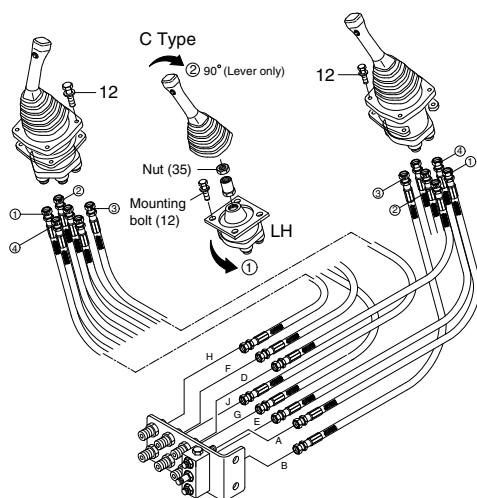

※ Whenever a change is made to the machine control pattern, also exchange the pattern label in the cab to match the new pattern.

※ The hose modification works must be carried out between RCV lever and terminal block (Not between terminal block and MCV).

60A40P50

| Pattern | Operation | | Control function | Hose connection (port) | | | |
|-----------------------------------|----------------|-----------------|------------------|------------------------|--------------------------|------|--|
| | Left RCV lever | Right RCV lever | | RCV lever | Change of Terminal block | | |
| | | | | | From | To | |
| ISO Type | | | Left | 1 Arm out | ② | D | - |
| HD Hyundai Construction Equipment | | | Left | 2 Arm in | ④ | E | - |
| | | | | 3 Swing right | ③ | B | - |
| | | | | 4 Swing left | ① | C | - |
| | | | | Right | 5 Boom lower | ④ | G |
| | | | 6 Boom raise | | ② | F | - |
| | | | 7 Bucket out | | ① | H | - |
| | | | 8 Bucket in | | ③ | J | - |
| | | | A Type | | | Left | 1 Boom lower |
| | | | Left | 2 Boom raise | ④ | E | F |
| | | | | 3 Swing right | ③ | B | - |
| | | | | 4 Swing left | ① | C | - |
| | | | | Right | 5 Arm out | ④ | G |
| | | | 6 Arm in | | ② | F | E |
| | | | 7 Bucket out | | ① | H | - |
| | | | 8 Bucket in | | ③ | J | - |
| | | | B Type | | | Left | 1 Boom lower |
| | | | Left | 2 Boom raise | ④ | E | F |
| | | | | 3 Bucket in | ③ | B | J |
| | | | | 4 Bucket out | ① | C | H |
| | | | | Right | 5 Arm out | ④ | G |
| | | | 6 Arm in | | ② | F | E |
| | | | 7 Swing right | | ① | H | B |
| | | | 8 Swing left | | ③ | J | C |
| | | | C Type | | | Left | ① Loosen the RCV lever mounting bolt (12) and rotate lever assy 90° counterclockwise; then install. ② To put lever in correct position, disassemble nut (35) and rotate only lever 90° clockwise. |
| | | | Right | Same as ISO type | | | |

2) PATTERN CHANGE VALVE INSTALL (option)

- ※ If the machine is equipped with the pattern change solenoid valve, the machine operation pattern can be easily changed.
- ※ Whenever a change is made to the machine control pattern also exchange the pattern label in the cab to match the new pattern.

| Operation | ISO type | A type |
|-----------------|----------|--------|
| Left RCV lever | | |
| Right RCV lever | | |

(1) The machine control pattern can be changed from the "ISO type" to "A type" by changing the position of the pattern change switch.

▲ Before starting the machine, check the lever position of pattern change switch and actual operating of attachment.

(2) Change of operating pattern

Pulling the safety button and press the switch to ISO type position (①) or A type position (②).

① : ISO type

② : A type

※ Refer to page 3-34 for the pattern change switch.

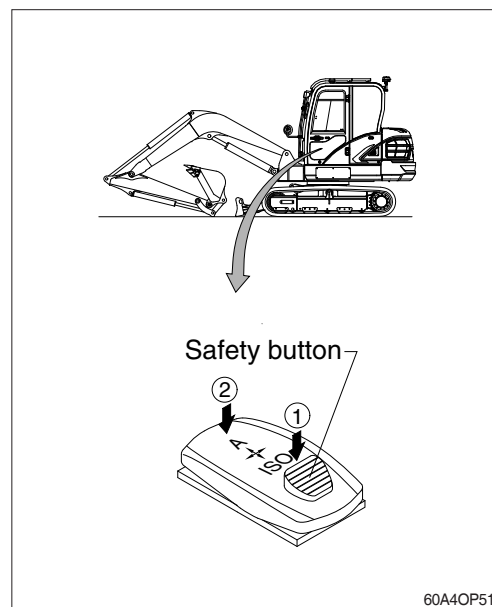

60A4OP51